



Floor Area: 154m²

The *Waitaia* is designed as a compact home with a small footprint and narrow in width. The home includes everything one needs in a modern home and can be suited to a large number of sections.

The change in exterior shapes allows for two cladding types to be used and look great while doing so. The hallway of this home can also be extended to add another room or brought in to make it a two bedroom home.

Your money is well spent on a cost effective, yet architectural home with this new home design.

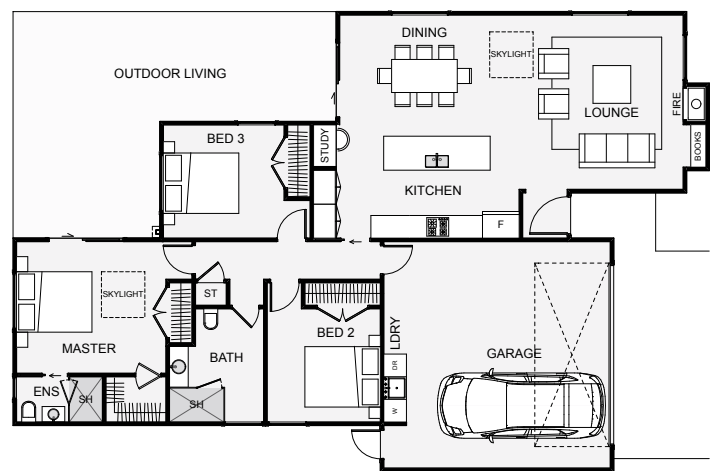

Contact Andre Mayo

Mobile: 021 201 9483

Phone: 0800 CASSA HOMES

Email: info@cassahomes.co.nz

Website: www.cassahomes.co.nz